

PLAT OF YAMATO VILLAGE CENTER

BEING A REPLAT OF A PORTION OF TRACTS 123 AND 124, BLOCK 73, PALM BEACH FARMS COMPANY PLAT NO. 3, AS RECORDED IN PLAT BOOK 2, PAGES 45 THRU 54, PUBLIC RECORDS OF PALM BEACH COUNTY, FLORIDA, SAID PARCEL LYING IN SECTION 6, TOWNSHIP 47 SOUTH, RANGE 42 EAST, PUBLIC RECORDS OF PALM BEACH COUNTY, FLORIDA SHEET 1 OF 2 A PART OF MOON LAKE P.U.D. JULY, 1995

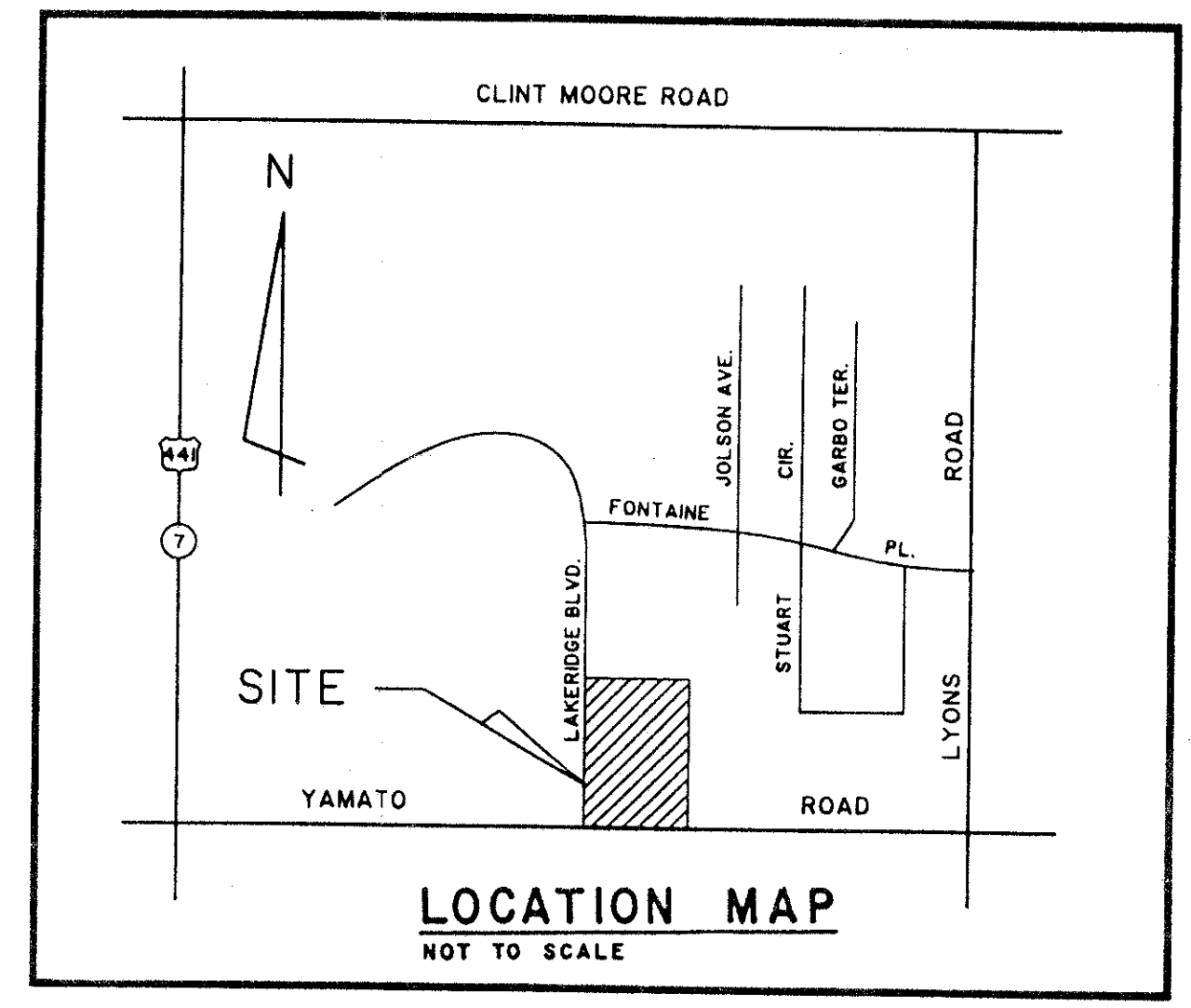

STATE OF FLORIDA
COUNTY OF PALM BEACH
This Plat was filed for record at 11:20 A.M. this 20th day of November 1995 and duly recorded in Plat Book No. 76 on Page 53-54
Dorothy H. Wilken, Clerk of the Circuit Court
By Dawn R. Masta, D.C.

DEDICATION AND RESERVATION

KNOW ALL MEN BY THESE PRESENTS THAT THE DRATAX CORP., A PENNSYLVANIA CORPORATION AUTHORIZED TO DO BUSINESS IN FLORIDA, OWNER OF THE LAND SHOWN HEREON BEING A REPLAT OF A PORTION OF TRACTS 123 AND 124, BLOCK 73, PALM BEACH FARMS COMPANY PLAT NO. 3, AS RECORDED IN PLAT BOOK 2, PAGES 45 THRU 54, PUBLIC RECORDS OF PALM BEACH COUNTY, FLORIDA, LYING IN SECTION 6, TOWNSHIP 47 SOUTH, RANGE 42 EAST, PALM BEACH COUNTY, FLORIDA, SHOWN HEREON AS YAMATO VILLAGE CENTER, BEING MORE PARTICULARLY DESCRIBED AS FOLLOWS:

BEGINNING AT THE SOUTHWEST CORNER OF TRACT "G" AS SHOWN ON WEITZER SUBDIVISION P.U.D. PLAT NO. THREE AS RECORDED IN PLAT BOOK 53, PAGES 72 THRU 77 OF THE PUBLIC RECORDS OF PALM BEACH COUNTY, FLORIDA, SAID POINT ALSO BEING ON THE EASTERLY RIGHT-OF-WAY LINE OF LAKERIDGE BOULEVARD AS SHOWN ON WEITZER SUBDIVISION P.U.D. PLAT NO. TWO, AS RECORDED IN PLAT BOOK 60, PAGES 180 THRU 183 OF THE PUBLIC RECORDS OF PALM BEACH COUNTY, FLORIDA; THENCE SOUTH 89°58'24" EAST ALONG THE SOUTH LINE OF TRACT "G" OF SAID WEITZER SUBDIVISION P.U.D. PLAT NO. THREE, A DISTANCE OF 389.80 FEET; THENCE SOUTH 00°04'53" WEST ALONG THE WEST LINE OF SAID TRACT "G", A DISTANCE OF 384.00 FEET TO A POINT ON THE NORTH RIGHT-OF-WAY LINE OF YAMATO ROAD AS SHOWN ON SAID WEITZER SUBDIVISION P.U.D. PLAT NO. THREE; THENCE NORTH 89°58'24" WEST ALONG SAID RIGHT-OF-WAY LINE, A DISTANCE OF 359.96 FEET; THENCE NORTH 44°56'42" WEST, A DISTANCE OF 58.80 FEET TO A POINT ON THE EAST RIGHT-OF-WAY LINE OF LAKERIDGE BOULEVARD AS SHOWN ON SAID WEITZER SUBDIVISION P.U.D. PLAT NO. TWO; THENCE NORTH 00°05'00" EAST ALONG SAID RIGHT-OF-WAY LINE, A DISTANCE OF 60.02 FEET TO A POINT OF CURVATURE OF A CURVE CONCAVE TO THE EAST, HAVING A CENTRAL ANGLE OF 04°04'14" AND A RADIUS OF 4,000.00 FEET; THENCE NORTHERLY ALONG THE ARC OF SAID CURVE AND SAID RIGHT-OF-WAY LINE, A DISTANCE OF 284.19 FEET TO THE POINT OF BEGINNING.

CONTAINING 3.49 ACRES MORE OR LESS.

HAS CAUSED THE SAME TO BE SURVEYED AND PLATTED AS SHOWN HEREON AND DO HEREBY DEDICATE AS FOLLOWS:

1. EASEMENTS:

THE LIMITED ACCESS EASEMENTS AS SHOWN HEREON ARE HEREBY DEDICATED TO THE BOARD OF COUNTY COMMISSIONERS OF PALM BEACH COUNTY, FLORIDA FOR THE PURPOSE OF CONTROL AND JURISDICTION OVER ACCESS RIGHTS.

THE UTILITY EASEMENTS AS SHOWN HEREON ARE HEREBY DEDICATED IN PERPETUITY FOR THE CONSTRUCTION AND MAINTENANCE OF UTILITY FACILITIES, INCLUDING CABLE TELEVISION SYSTEMS. THE INSTALLATION OF CABLE TELEVISION SYSTEMS SHALL NOT INTERFERE WITH THE CONSTRUCTION AND MAINTENANCE OF OTHER UTILITIES.

THE LANDSCAPE BUFFERS, AS SHOWN HEREON, ARE HEREBY RESERVED FOR THE DRATAX CORP., ITS SUCCESSORS AND ASSIGNS FOR LANDSCAPING AND BUFFER PURPOSES AND ARE THE PERPETUAL MAINTENANCE OBLIGATION OF SAID PARTNERSHIP, ITS SUCCESSORS AND ASSIGNS, WITHOUT RECOURSE TO PALM BEACH COUNTY.

2. TRACTS:

TRACT "A", AS SHOWN HEREON, IS HEREBY RESERVED FOR THE DRATAX CORP., ITS SUCCESSORS AND ASSIGNS FOR COMMERCIAL DEVELOPMENT AND IS THE PERPETUAL MAINTENANCE OBLIGATION OF SAID PARTNERSHIP, ITS SUCCESSORS AND ASSIGNS, WITHOUT RECOURSE TO PALM BEACH COUNTY.

IN WITNESS WHEREOF, THE ABOVE-NAMED CORPORATION HAS CAUSED THESE PRESENTS TO BE SIGNED BY ITS PRESIDENT AND ATTESTED BY ITS SECRETARY AND ITS CORPORATE SEAL TO BE AFFIXED HERETO AND WITH THE AUTHORITY OF ITS BOARD OF DIRECTORS, THIS 5TH DAY OF October, 1995.

DRATAX CORP.,
A PENNSYLVANIA CORPORATION,
AUTHORIZED TO DO BUSINESS IN FLORIDA
ATTEST: *Richard Taxin* BY: *Joseph M. Dratch*
RICHARD TAXIN, SECRETARY JOSEPH M. DRATCH, PRESIDENT

ACKNOWLEDGEMENT

STATE OF PENNSYLVANIA
COUNTY OF MONTGOMERY

BEFORE ME PERSONALLY APPEARED JOSEPH M. DRATCH AND RICHARD TAXIN WHO ARE PERSONALLY KNOWN TO ME, AND WHO EXECUTED THE FOREGOING INSTRUMENT AS PRESIDENT & SECRETARY OF DRATAX CORP., A PENNSYLVANIA CORPORATION AUTHORIZED TO DO BUSINESS IN THE STATE OF FLORIDA, AND SEVERALLY ACKNOWLEDGED TO AND BEFORE ME THAT THEY EXECUTED SUCH INSTRUMENT AS SUCH OFFICERS OF SAID CORPORATION, AND THAT THE SEAL AFFIXED TO THE FOREGOING INSTRUMENT IS THE CORPORATE SEAL OF SAID CORPORATION AND THAT IS WAS AFFIXED TO SAID INSTRUMENT BY DUE AND REGULAR CORPORATE AUTHORITY, AND THAT SAID INSTRUMENT IS THE FREE ACT AND DEED OF SAID CORPORATION

WITNESS MY HAND AND OFFICIAL SEAL THIS 5TH DAY OF October, 1995

MY COMMISSION EXPIRES: 3/9/98 *Susan H. Tarshis*
NOTARY PUBLIC

NOTARIAL SEAL
SUSAN H. TARSHIS, Notary Public
Whippany Twp., Montgomery Co.
My Commission Expires March 9, 1998

ACCEPTANCE OF RESERVATIONS

STATE OF PENNSYLVANIA
COUNTY OF MONTGOMERY

THE DRATAX CORP. HEREBY ACCEPTS THE DEDICATIONS OR RESERVATIONS TO SAID CORPORATION AS STATED AND SHOWN HEREON, AND HEREBY ACCEPTS ITS MAINTENANCE OBLIGATIONS FOR SAME AS STATED HEREON, DATED THIS 5TH DAY OF October, 1995.

DRATAX CORP.
A PENNSYLVANIA CORPORATION
AUTHORIZED TO DO BUSINESS IN FLORIDA

WITNESS: *Joseph M. Dratch* BY: *Joseph M. Dratch*
JOSEPH M. DRATCH, PRESIDENT

ACKNOWLEDGEMENT

STATE OF PENNSYLVANIA
COUNTY OF MONTGOMERY

BEFORE ME PERSONALLY APPEARED JOSEPH M. DRATCH, WHO IS PERSONALLY KNOWN TO ME, AND WHO EXECUTED THE FOREGOING INSTRUMENT AS PRESIDENT OF DRATAX CORP., A PENNSYLVANIA CORPORATION, AUTHORIZED TO DO BUSINESS IN FLORIDA, AND SEVERALLY ACKNOWLEDGED TO AND BEFORE ME THAT HE EXECUTED SUCH INSTRUMENT AS SUCH OFFICER OF SAID CORPORATION, AND THAT THE SEAL AFFIXED TO THE FOREGOING INSTRUMENT IS THE CORPORATE SEAL OF SAID CORPORATION AND THAT IT WAS AFFIXED TO SAID INSTRUMENT BY DUE AND REGULAR CORPORATE AUTHORITY, AND THAT SAID INSTRUMENT IS THE FREE ACT AND DEED OF SAID CORPORATION.

WITNESS MY HAND AND SEAL THIS 5TH DAY OF October, 1995

MY COMMISSION EXPIRES: 3/9/98 *Susan H. Tarshis*
NOTARY PUBLIC

NOTARIAL SEAL
SUSAN H. TARSHIS, Notary Public
Whippany Twp., Montgomery Co.
My Commission Expires March 9, 1998

TITLE CERTIFICATION

STATE OF FLORIDA
COUNTY OF BROWARD

WE, LAWYERS TITLE INSURANCE CORPORATION, A TITLE INSURANCE COMPANY, AS DULY LICENSED IN THE STATE OF FLORIDA, DO HEREBY CERTIFY THAT WE HAVE EXAMINED THE TITLE TO THE HEREON DESCRIBED PROPERTY; THAT WE FIND THE TITLE TO THE PROPERTY IS VESTED TO DRATAX CORP.; THAT THE CURRENT TAXES HAVE BEEN PAID; THAT THERE ARE NO MORTGAGES OF RECORD; AND THAT THERE ARE NO OTHER ENCUMBRANCES OF RECORD.

DATED: 10/13/95 *Frederick Hersaud*
FREDERICK HERSAUD
VICE PRESIDENT AND
SOUTH FLORIDA AREA MANAGER

SURVEYOR'S NOTES:

- DENOTES PERMANENT REFERENCE MONUMENTS #5019 (P.R.M.)
- IN THOSE CASES WHERE EASEMENTS OF DIFFERENT TYPES CROSS OR OTHERWISE COINCIDE, DRAINAGE EASEMENTS SHALL HAVE FIRST PRIORITY, UTILITY EASEMENTS SHALL HAVE SECOND PRIORITY, ACCESS EASEMENTS SHALL HAVE THIRD PRIORITY, AND ALL OTHER EASEMENTS SHALL BE SUBORDINATE TO THESE WITH THEIR PRIORITIES BEING DETERMINED BY USE RIGHTS GRANTED.
- BEARINGS AS SHOWN HEREON ARE BASED UPON THE SOUTH LINE OF WEITZER SUBDIVISION P.U.D. PLAT NO. 3, AS RECORDED IN PLAT BOOK 53, PAGES 72 THRU 77, PUBLIC RECORDS OF PALM BEACH COUNTY, FLORIDA, HAVING A PLATTED BEARING OF SOUTH 89°58'24" EAST AND ALL OTHER BEARINGS ARE RELATIVE THERETO.
- NO BUILDING OR ANY KIND OF CONSTRUCTION OR TREES OR SHRUBS SHALL BE PLACE ON ANY EASEMENT WITHOUT PRIOR WRITTEN CONSENT OF ALL EASEMENT BENEFICIARIES AND ALL APPLICABLE COUNTY APPROVALS OR PERMITS AS REQUIRED FOR SUCH ENCROACHMENTS.
- THERE MAY BE ADDITIONAL RESTRICTIONS THAT ARE NOT RECORDED ON THIS PLAT THAT MAY BE FOUND IN THE PUBLIC RECORDS OF PALM BEACH COUNTY, FLORIDA.
- P.U.D. DENOTES PLANNED UNIT DEVELOPMENT
U.E. DENOTES UTILITY EASEMENTS
R DENOTES RADIUS
P.O.B. DENOTES POINT OF BEGINNING
P.R.M. DENOTES PERMANENT REFERENCE MONUMENT
L DENOTES ARC LENGTH
Δ DENOTES DELTA ANGLE
CL DENOTES CENTERLINE
NR DENOTES NON-RADIAL LINE
O.A. DENOTES OVERALL DIMENSION
FND. DENOTES FOUND
PBCO DENOTES PALM BEACH COUNTY
CONC. DENOTES CONCRETE
MON. DENOTES MONUMENT
P.S.M. DENOTES PROFESSIONAL SURVEYOR & MAPPER
L.A.E. DENOTES LIMITED ACCESS EASEMENT
O.R.B. DENOTES OFFICIAL RECORD BOOK

PET. 80-206
ALOC. #0001
5/3/3/M

COUNTY APPROVAL

STATE OF FLORIDA
COUNTY OF PALM BEACH

COUNTY ENGINEER:

THIS PLAT IS HEREBY APPROVED FOR RECORD PURSUANT TO PALM BEACH COUNTY ORDINANCE 95-33, AND IN ACCORDANCE WITH SEC. 177.071 (2), F.S., THIS 20 DAY OF Nov, 1995.

George T. Webb
GEORGE T. WEBB, P.E. - COUNTY ENGINEER

SURVEYOR'S CERTIFICATE

THIS IS TO CERTIFY THAT THE PLAT SHOWN HEREON IS A TRUE AND CORRECT REPRESENTATION OF A SURVEY MADE UNDER MY RESPONSIBLE DIRECTION AND SUPERVISION; THAT SAID SURVEY IS ACCURATE TO THE BEST OF MY KNOWLEDGE AND BELIEF; THAT PERMANENT REFERENCE MONUMENTS ("P.R.M.'S") HAVE BEEN PLACED AS REQUIRED BY LAW; AND, FURTHER, THAT THE SURVEY DATA COMPLIES WITH ALL THE REQUIREMENTS OF CHAPTER 177, FLORIDA STATUTES, AS AMENDED, AND THE ORDINANCES OF PALM BEACH COUNTY, FLORIDA.

DATE: 10/16/95 *Craig S. Pusey*
CRAIG S. PUSEY, P.E.M.
LICENSE NO. 5019
STATE OF FLORIDA

THIS INSTRUMENT WAS PREPARED BY LESLIE BISPOTT, UNDER THE SUPERVISION OF CRAIG S. PUSEY, P.S.M. OF LANDMARK SURVEYING AND MAPPING, INC.

0349-009

76/53

TAZ-769

SUBDIVISION * Yamato Village Center
BOOK 76
PAGE 53
FLOOD MAP #215A
QUAD # 53
ZONING RS
SE 80-206
ZIP CODE 33434
PUD NAME MOON LAKE

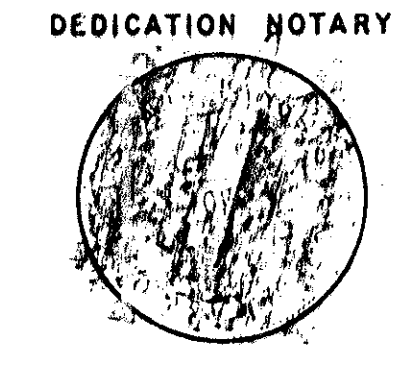

YAMATO VILLAGE CENTER

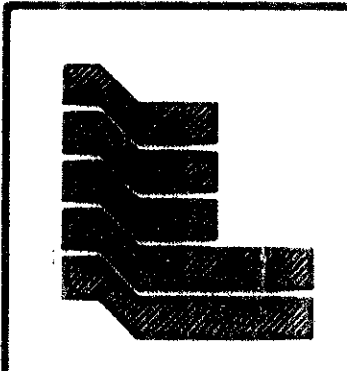
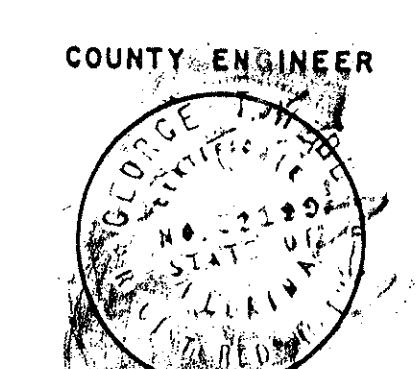
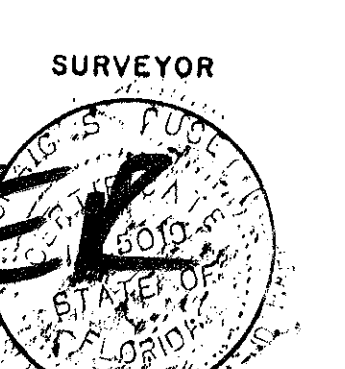
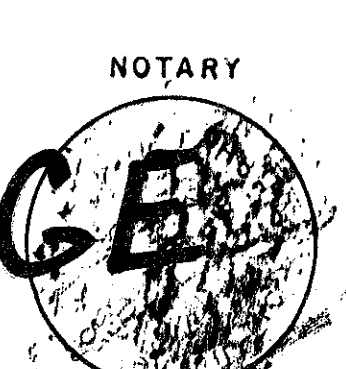
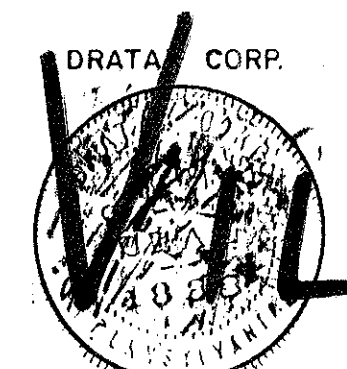

Landmark Surveying & Mapping Inc.
1850 FOREST HILL BOULEVARD
PH. (407)433-5405 SUITE 100 W.P.B. FLORIDA
PLAT OF
YAMATO VILLAGE CENTER